

› **PRACTICATRIO**

**WE EXPAND
YOUR PARKING
CAPACITY**



San  **Park**

DATASHEET

Practicatrio	Modules							
	M3	M4	M5	M6	M7	M8	M9	M10
parking capacity	8 cars	11 cars	14 cars	17 cars	20 cars	23 cars	26 cars	29 cars

» PRACTICATRIO INSTALLATION

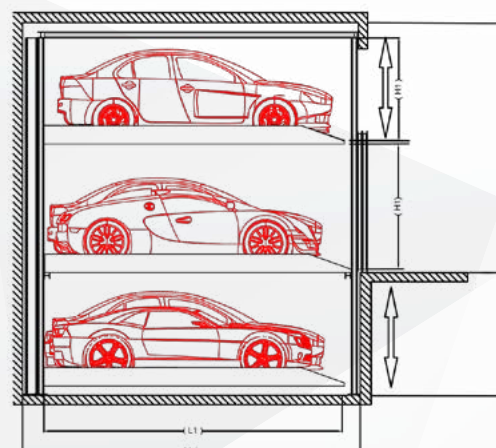
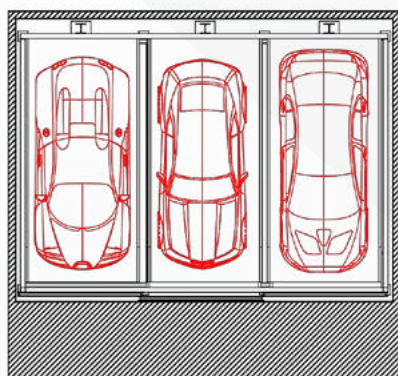
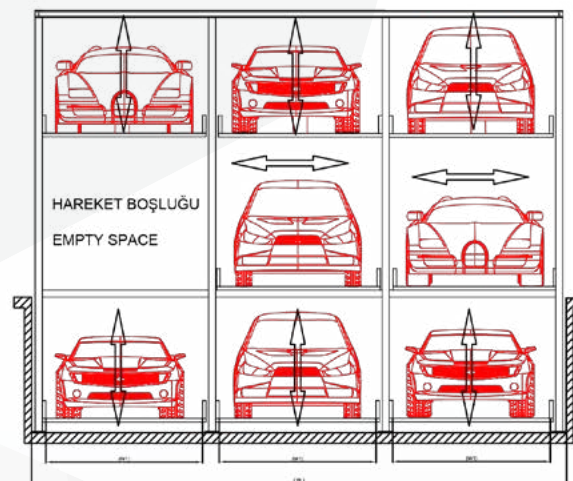
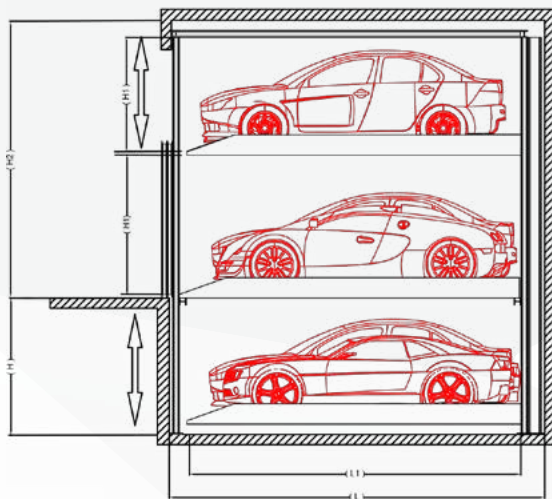

Practicatrio outdoor place dimensions		
Explanation		Practicatrio / M3
Platform Length	L1	520 cm
Platform Width	W1	230 cm
Pit Width	W	750 - 2700 cm
Pit Length	L	550 - 560 cm
Pit Depth	H	180 - 220 cm
Entrance Level Clearance Height	H1	160 - 210 cm
Upper Platform Height	H1	160 - 210 cm
Entrance Ceiling Height	H2	350 - 450 cm
Lifting Capacity		2000 - 2500 kg
Vehicle Call Time		60 sn
Motor		4 kw / 3 Phase

» AUTOMATIC SLIDING DOOR

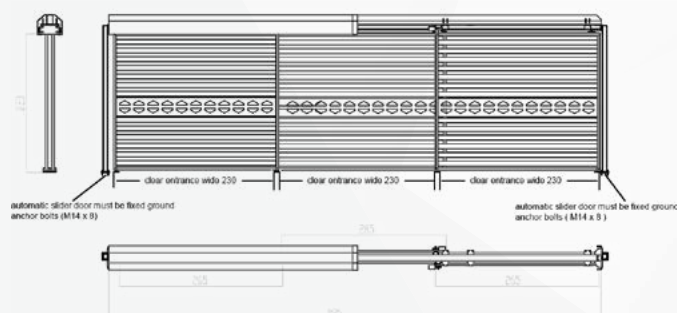

» PRACTICATRIO INSTALLATION

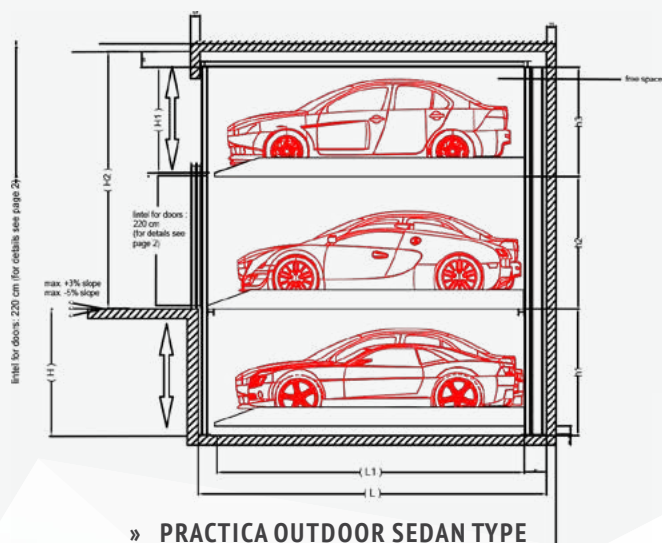

» CLEARANCE CAR DIMENSIONS

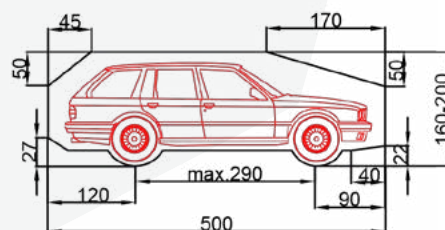

The total car height includes roof rail and antenna.
Car height must not exceed the above max. car dimensions

» PRACTICATRIO WIDTH DIMENSIONS

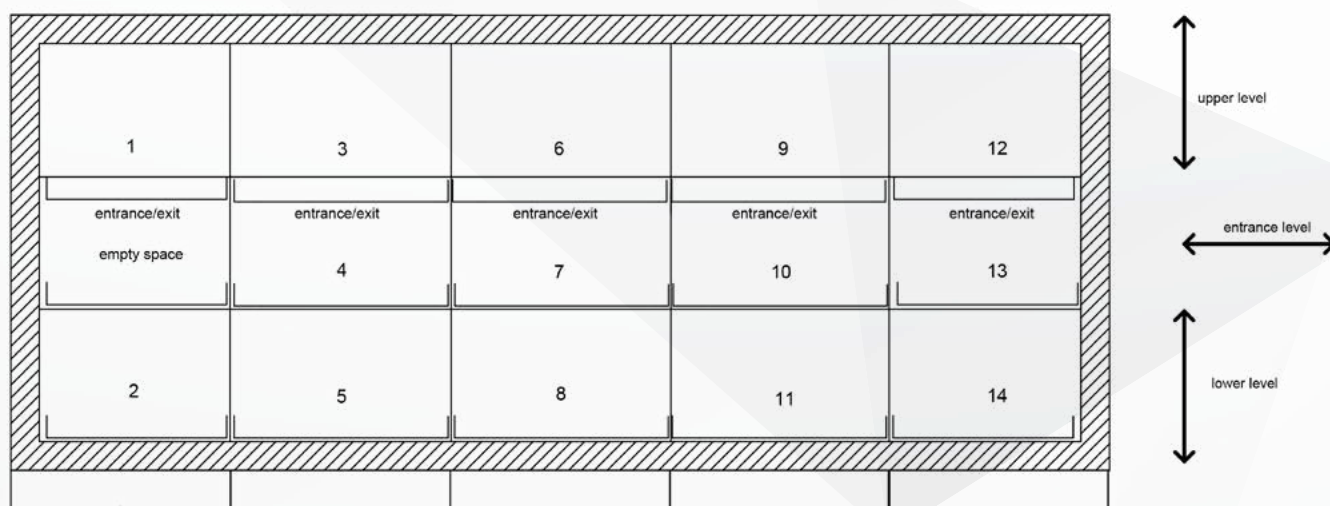

Space Required		gives clear platform width
B	B1	
260	250	230
270	260	240
280	270	250
290	280	260
300	290	270

One entry/exit is required on entrance level for each grid.

» FOUNDATION LOADS AND CONSTRUCTION

PRACTICATRIO INDOOR INSTALLATION

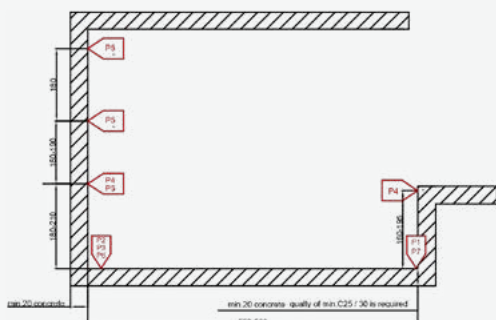

static load factor practicapark M4
car max.weight :2000 kg

load point	type
P1	+50,0 KN
P2	+72,0 KN
P3	±30,0 KN
P4	±4,0 KN
P5	±6,0 KN
P6	±30,0KN
67	±15,0KN

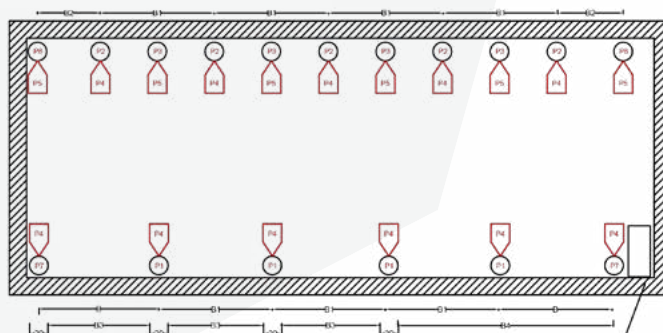

5,5 kw hyraulic power pack
40x70x80

Space Required					gives clear platform width
B	B1	B2	B3	B4	
260	250	135	230	480	230
270	260	140	240	500	240
280	270	145	250	520	250
290	280	150	260	540	260
300	290	155	270	560	270

5,5 kw hyraulic power pack
40x70x80

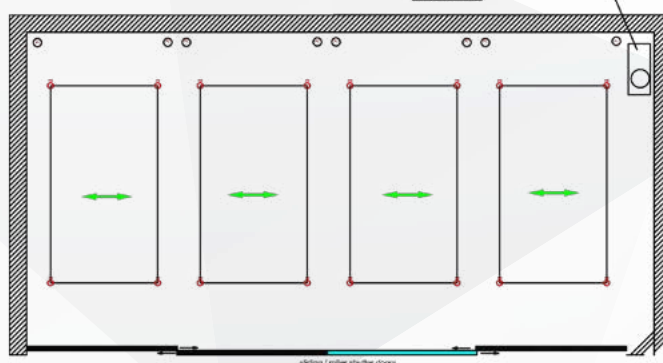

dimensions in brackets for longer units

***dimensions for comfort type**

****dimensions for compact type**

CUSTOMER RESPONSIBILITY :

Electricity supply panel will be installed in the installation area at the location specified by the manufacturer on the project.

Power line to the supply panel will be made with 5x4 mm² TTR cable. (3 PH + N + PE)

There must be a 3x16 amp fuse in the electric box there should be a circuit breaker on the supply panel.

FIXING OF THE SYSTEM FRAMES TO THE FLOOR PL

* Using adhesive anchor bolts hole depth to 12-15 cm

* anchor bolt diameter: 2 cm

CONCRETE QUALITY GRADE :

*compliant to the static requirements of the construction min.C25 / 30 grade

» DESCRIPTION OF PRACTICATRIO

Electrohydraulic Independent Semi Automatic Parking Lift

» GUIDEWAY

Clean the slides on which the material is located in the columns. Lubricate the throat parts of the pistons and the synchronization torque bearings with grease. This lubrication and cleaning should be done at monthly checks

» OIL SUMP

Open the command control chamber. If the oil is below the specified level, complete with ISO VG 46 oil. The lift must be at the lowest level when adding oil.

» HYDRAULIC AND ELECTRICAL CONNECTIONS

Check that the hydraulic connections and terminal connections in the electrical system are loose.

» MECHANIC CONNECTIONS

Check platform-column connections once a month and tighten if necessary

» SUITABILITY FOR USE

This machine is manufactured in accordance with European Community of design and safety directives 2006/42 EC and TS EN 14010.

The dynamic load test was carried out with a weight of 1-15 times the nominal load in accordance with the provisions of the EC Machinery Safety Directive 2006/42. In accordance with the same provision, the static load test was carried out at a weight of 1-5 times the nominal load. Attention; these tests only be carried out by qualified personnel.

Important Notes

- 1) Doors are not required for standard version. Doors can be installed either for automatic or manual opening
- 2) Arrangements start with 2 grids for 3 cars, 3 grids for 5 cars, etc.
- 3) The manufacturer has right to construction or model modifications and/or alterations. The right to any subsequent part modification and/or variations and amendments in procedures and standards due to technical and engineering process in the art or due to the environmental regulation changes, are also hereby reserved.

Track Installation-Flooring works-Drainage

- › The moving rail load of each platform wheel is max 10kN.

Hydraulic Power Packs

- › The hydraulic power pack is placed inside the system.

Switch Cabinet and Electrical Data

- › The switch cabinet is placed inside the system at the rear wall.

General Product Information

- › The Practica Park has 2 platform rows, one above the other. The drive way is in front of the lower platform.
- › In order to access the platform at the top, the lower platform shifts to the free space so that the selected upper platform can be lowered.

Noise Protection

- › The compliance with these measures must be carried out by the customer (DIN 4109)

Temperature

- › The operating temperatures are between 0 °C and +40°C. If local climate conditions are not suitable to use in between these temperatures, please contact with SANPARK.

Illumination

- › The customer should provide sufficient illumination with respect to the local requirements

Railings

- › If walkways are arranged directly to the side or behind systems, railings have to be provided by the costumer according to the local requirements. Minimum height is 2m.

Maintenance

- › Annual maintenance is performed at conclusion of a maintenance contract

Protection against Corrosion

- › The pit must always be deareted and ventilated.

Dimensions

- › All dimensions are in cm and all dimensions are minimum. The construction tolerances must be taken into consideration.

Fire Safety

- › The costumer must provide all the fire safety equipments (fire extinguisher, fire alarm systems, etc.).

Note

- › Installation of an empty pipe is recommended if the doors are planned. The pipe should be 120cm above the ground level in the center of a column.